



STROMAB

EXPERTS IN CROSSCUTTING SOLUTIONS SINCE 1965



STROMABSTOP

AUTOMATIC MEASUREMENT
POSITIONER

STROMABSTOP

STROMABSTOP is the automatic measurement positioner compatible with all machines in the STROMAB catalogue (RS, PS, TR, US) and all machines requiring position control.

It functions as an electronic stop and positioner. Its length is modular, the position is reversible (left and right), and the height is adjustable. The control panel is easy and intuitive to use. Anodised aluminium profile, 105 x 90 mm cross-section, toothed belt reinforced with 32 mm steel cables.



SMART 7

- Colour touchscreen control panel, 7"
- ABSOLUTE or INCREMENTAL working mode
- Eight preset common measurements
- Software with two levels of optimization (optional)
- Front USB port for importing cut lists and software updates

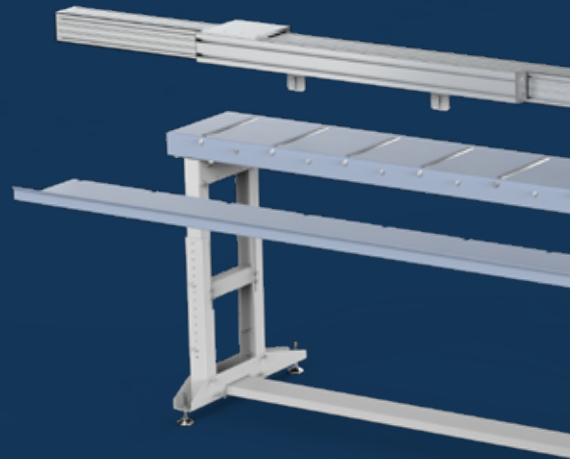

Technical Specifications

Motor	Power supply
Stepper motor, 6 Nm	Multi-voltage 115 - 230 VAC, 50/60 Hz single phase
Roller conveyor capacity up to 90 kg	Usable length 3000 / 4500 / 6000 / 7000 mm.
Maximum speed 60 m/min.	Repeatability precision +/- 0.1 mm.



TR501 + STROMABSTOP



US11 + STROMABSTOP

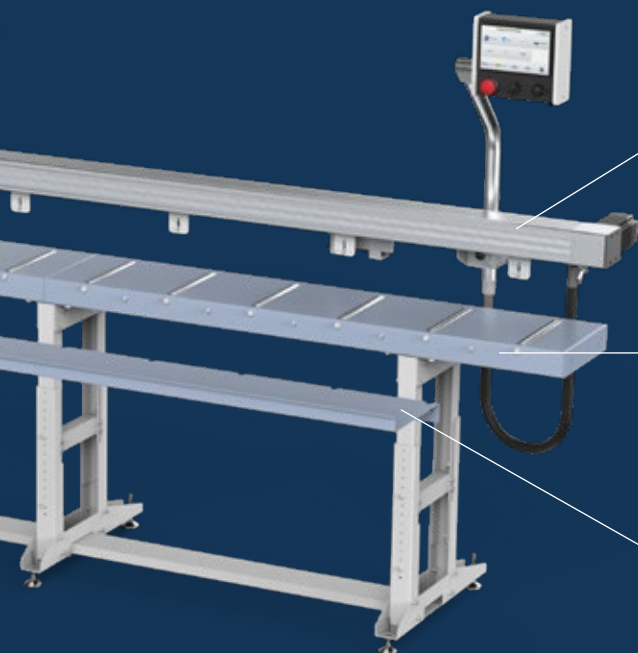

Standard version

Roller table,
Ø 32 mm idle rollers.
Width 260 mm.

Front support base

A



B



C

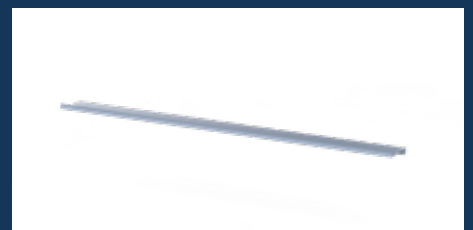



www.stromab.it

THE **VALUE** OF A FAMILY-OWNED COMPANY

Stromab has stood for reliability since 1965. And we believe that this word best expresses the philosophy behind our products over our more than 40 years in business. The awareness that no investment can offer greater advantages than customer satisfaction leads us to constantly devote new resources for ongoing research into technology, development and human resources. A constant growth trend is the natural result of a company policy based on the value of success in full compliance with environmental requirements. With a 5000 m²+ plant, 40 employees and a constantly updated line of products, Stromab has made a significant name for itself as one of the most dynamic companies in the woodworking machinery sector.

The technical data are not binding and may be subject to change for the purposes of technical improvement.



STROMAB

EXPERTS IN CROSSCUTTING SOLUTIONS SINCE 1965

STROMAB SPA

42012 CAMPAGNOLA EMILIA (RE) Italy
Via Zuccardi 28/a - Z.I. Ponte Vettigano
Tel. (0522) 1933300 - Fax (0522) 1933361
info@stromab.com - www.stromab.com